

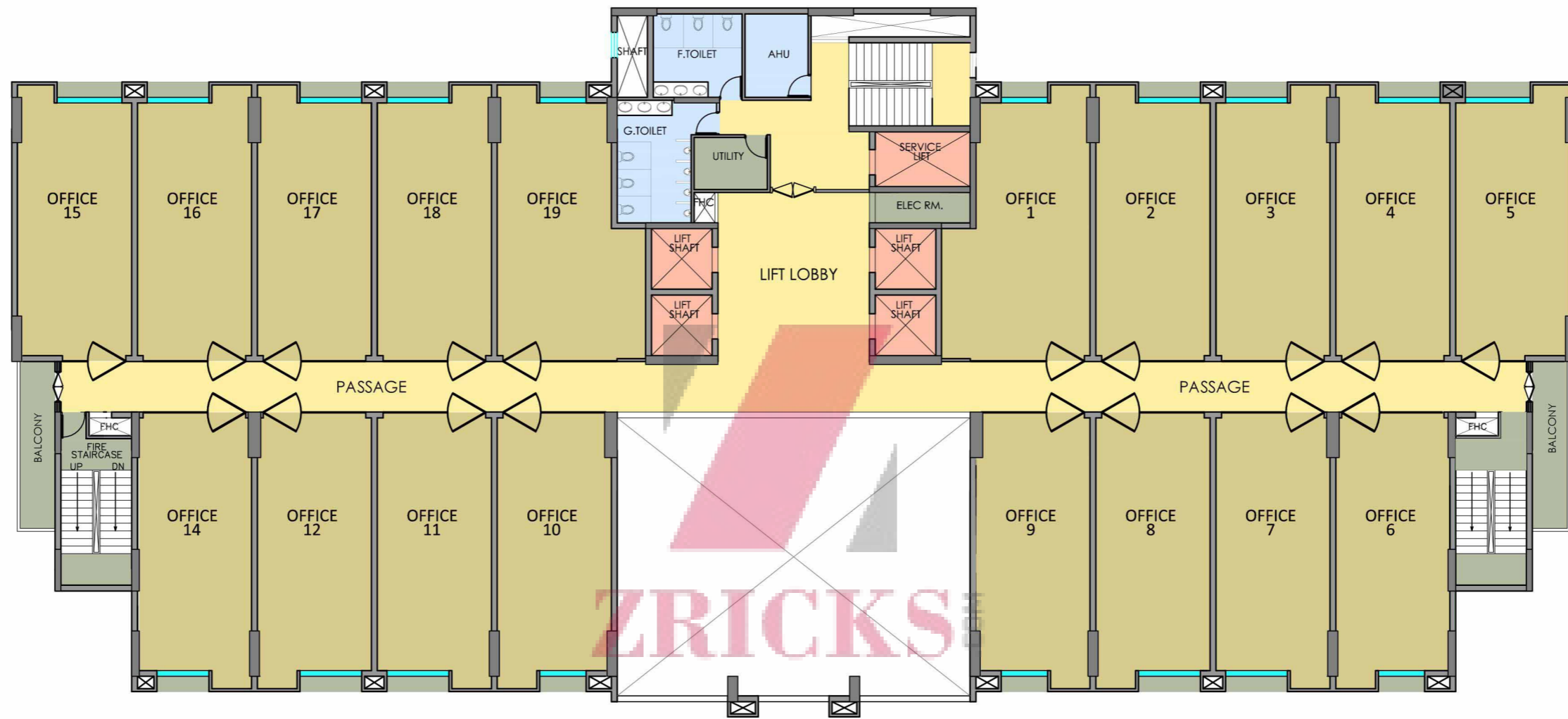



ZBRICKS



A T S BOUQUET SECTOR 132, NOIDA

TOWER A, FIRST FLOOR PLAN

Note: Saleable area/layout is tentative and is subject to change due to modifications asked for by approving authorities from time to time till occupancy certificate is obtained. Architects reserves the right to add/delete any detail/specification/elevation mentioned if so warranted by circumstances.

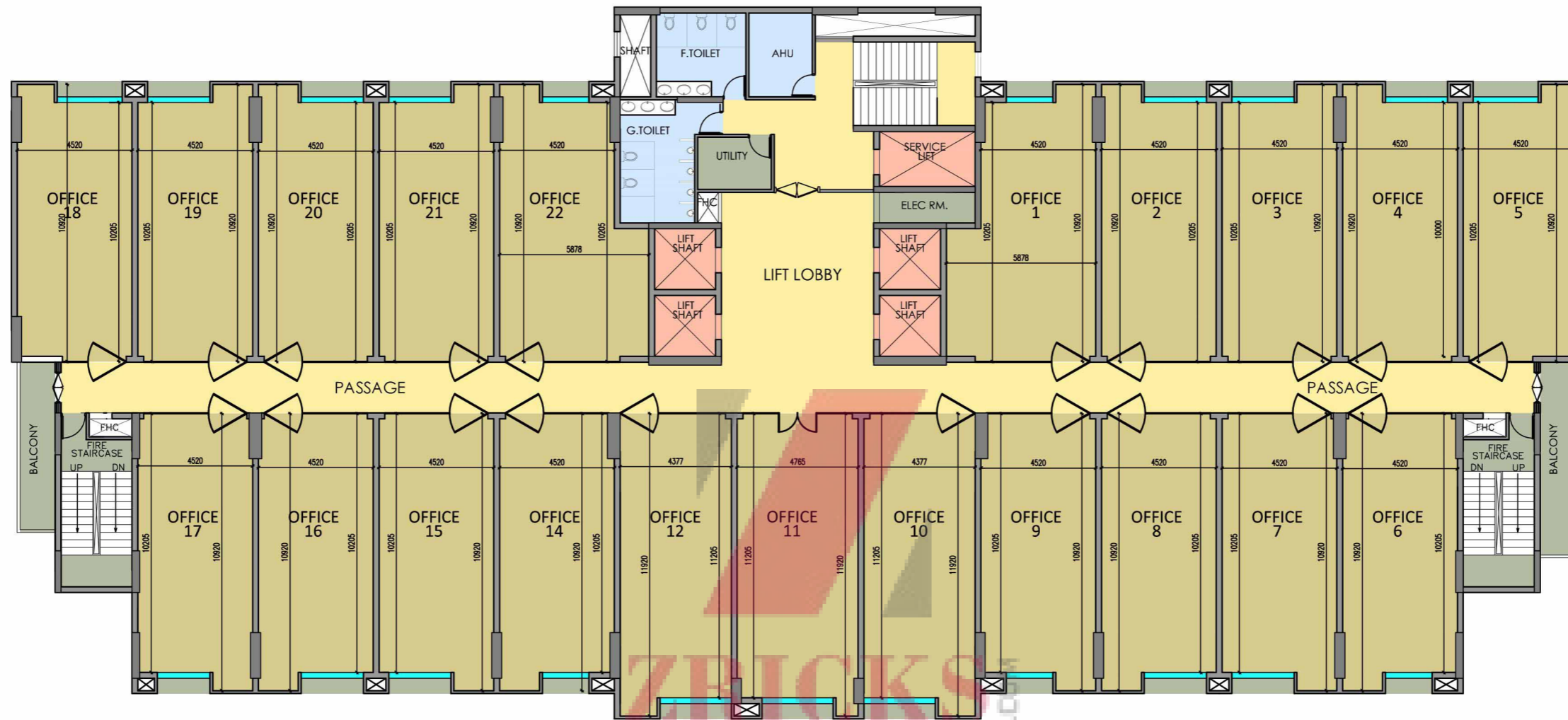

A T S BOUQUET SECTOR 132, NOIDA

TOWER A, TYPICAL FLOOR PLAN (2/3/4/5/6/7/8/9/10/11/12/14)

Note: Saleable area/layout is tentative and is subject to change due to modifications asked for by approving authorities from time to time till occupancy certificate is obtained. Architects reserves the right to add/delete any detail/specification/elevation mentioned if so warranted by circumstances.

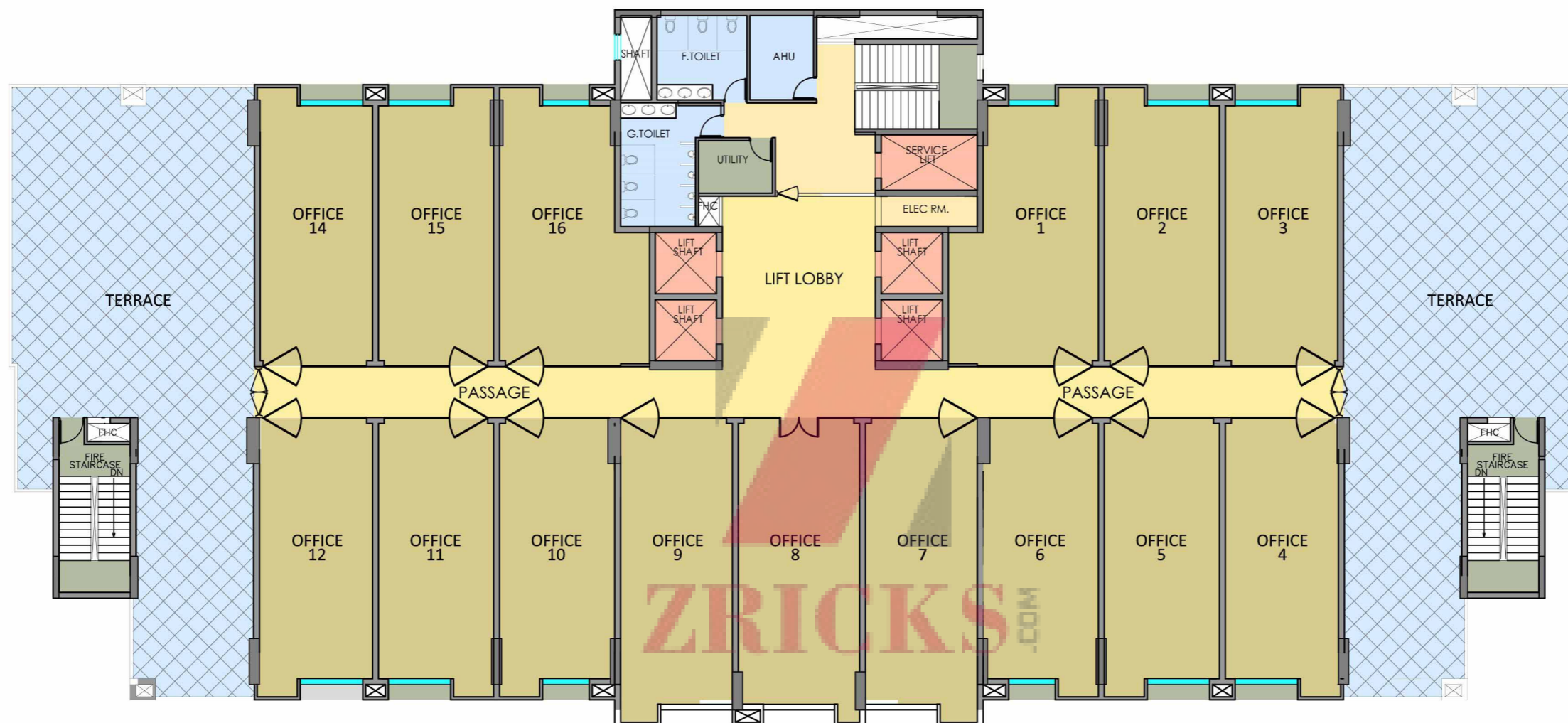

A T S BOUQUET SECTOR 132, NOIDA

TOWER A, 15TH FLOOR PLAN

Note: Saleable area/layout is tentative and is subject to change due to modifications asked for by approving authorities from time to time till occupancy certificate is obtained. Architects reserves the right to add/delete any detail/specification/elevation mentioned if so warranted by circumstances.

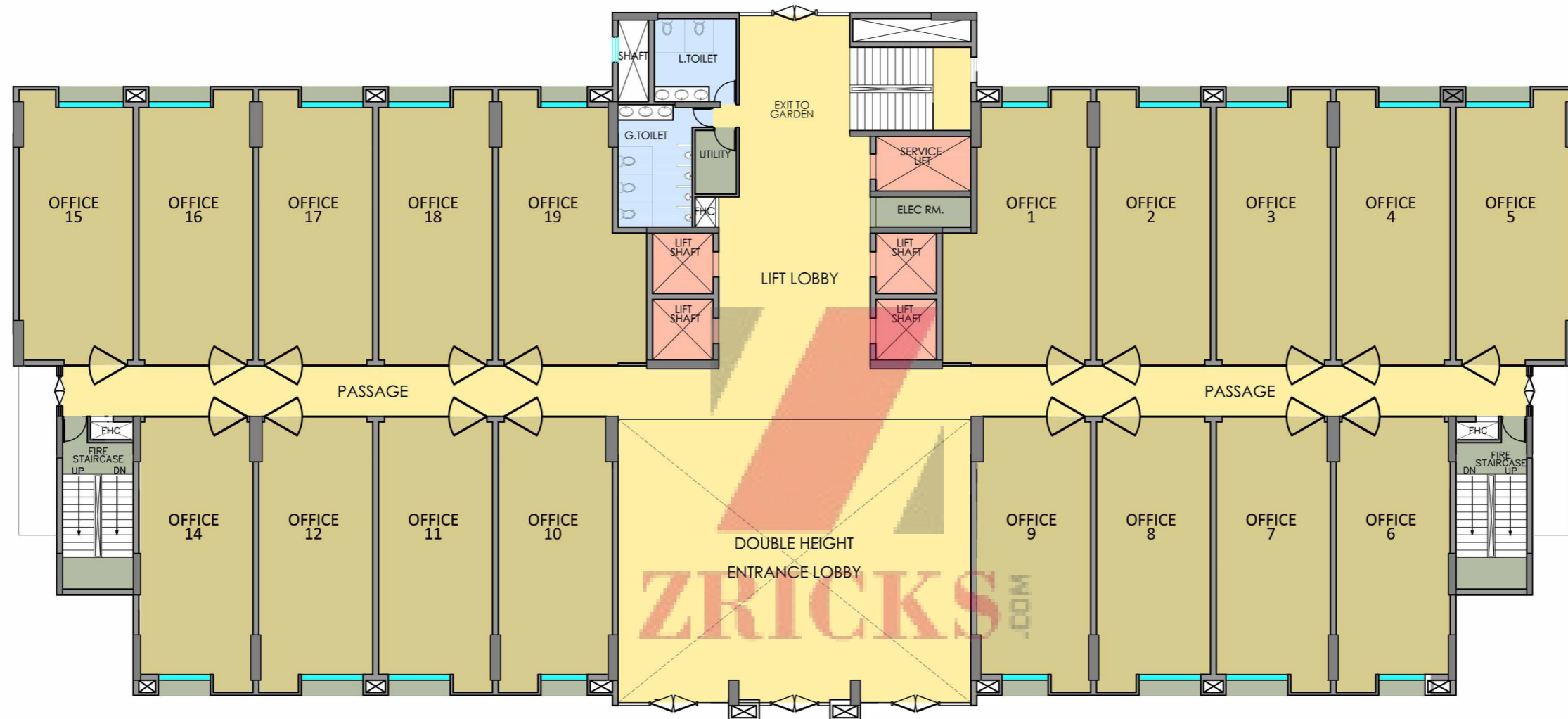

A T S BOUQUET SECTOR 132, NOIDA

TOWER A, GROUND FLOOR PLAN

Note: Saleable area/layout is tentative and is subject to change due to modifications asked for by approving authorities from time to time till occupancy certificate is obtained. Architects reserves the right to add/delete any detail/specification/elevation mentioned if so warranted by circumstances.



ATS BOUQUET SECTOR 132, NOIDA

SITE PLAN

Note: Saleable area/layout is tentative and is subject to change due to modifications asked for by approving authorities from time to time till occupancy certificate is obtained. Architects reserves the right to add/delete any detail/specification/elevation mentioned if so warranted by circumstances.



NOIDA
EXTENSION

SECTOR 82

SECTOR 128

SECTOR 93

SECTOR 132

ZRICKS

SECTOR 137

PARAS TIERA

Nangli Village

Bajidpur

SECTOR 168

Google